

June 1, 2024
Medina Gazette Edition

medinacountyparks.com
(330) 722-9364

Leaflet

Your Connection to Nature  Medina County Park District

Board of Commissioners
Kathleen E. Davis
Dennis B. Neate
Jason C. Venner

Nathan D. Eppink, Director
Jill M. Teubl, Editor

 Facebook
@MedinaCountyParkDistrict

 Formerly Twitter
@medinacoparks

 Instagram
@medinacountyparks

Get Ready for Adventure: Exciting New Playscape Coming Soon to Allardale Park!

The legacy of the Allards continues to grow.

Stan and Esther Allard donated 125 acres to Medina County Park District in 1992. Thanks to strategic acquisitions in the decades that followed, the park—located in Granger Township—is nearly 400 acres today. Its rolling hills, hiking trails, and a beautiful, reservable lodge (designed by architect David Allard, a nephew of the couple) make Allardale one of the district's most popular destinations.

This summer, a new playscape will take shape near the former Allard home-stead, just west of the hiking trail parking lot at 401 Remsen Road. Children of all ages will soon discover a new, exciting way to connect with nature through this innovative playscape. The project is generously supported by the Allards' nieces and nephews, who have pledged \$250,000 toward the construction of this new amenity.

The concept of a playscape honoring the property's agricultural heritage was first envisioned over a decade ago. Through ongoing discussions and evolving ideas, a comprehensive plan was developed. With the Allards' guidance and financial backing, the new playscape will feature a hillside slide, climbing structures, a wooden tractor, a short trail, and more. Emphasizing sustainability, the project will utilize repurposed materials, native plants, and a 'DIY' aesthetic that would resonate with Stan and Esther's values.

Instilling a love for the outdoors in children is the heart and soul of the playscape project. This addition to Allardale Park will, undoubtedly, enhance the park's appeal and serve as a fitting tribute to the Allard family's lasting legacy.

Weather permitting, it is expected to be completed by Labor Day.

Inspirational images

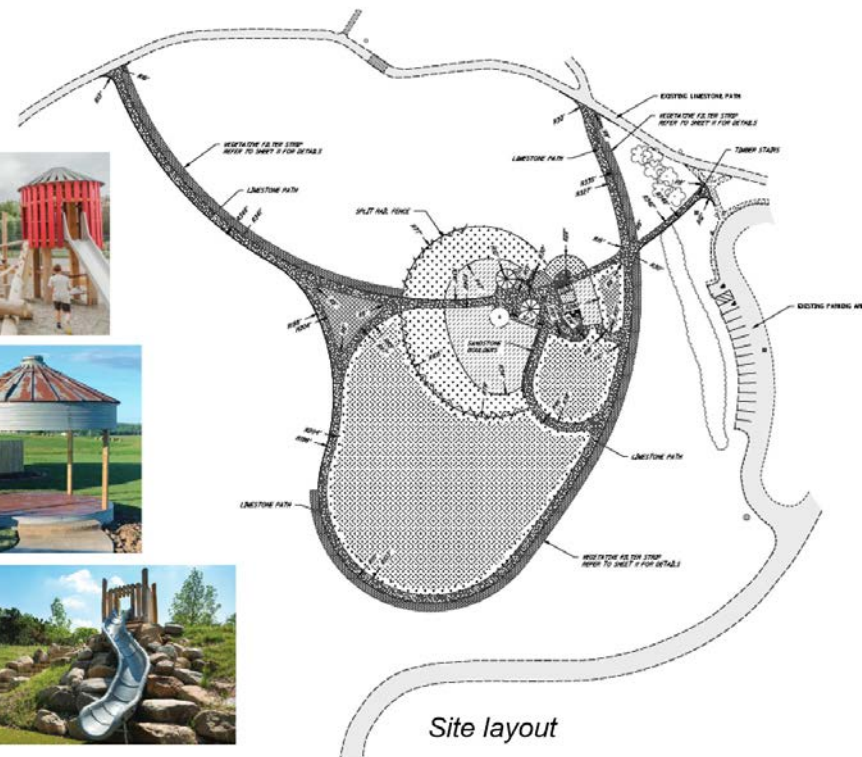

The photos above are examples of the various types of structures and play features that will be installed at the new playscape at Allardale Park later this summer.

June, July, and August programs are available online at [MedinaCountyParks.com](https://www.medinacountyparks.com).



CASH OR CHECKS ARE ACCEPTED FOR PAYMENT.

BRING YOUR OWN BOX FOR CARRYING PLANTS HOME.

Native Plant Sale

Oenslager Nature Center
6100 Ridge Road
Sharon Township
(use Wadsworth for city if using a GPS)

WEEKENDS THIS SUMMER:

JUNE 15 AND 16
JUNE 22 AND 23
JUNE 29 AND 30

JULY 13 AND 14
JULY 20 AND 21
JULY 27 AND 28

SATURDAY HOURS
10 A.M. - 4 P.M.

SUNDAY HOURS
1 - 4 P.M.

Friends of Medina County Parks has a great opportunity for you to get fabulous native plants for your landscaping. A variety of species in limited quantities are available. Come see what we have to offer! Plants are grown by Camel Creek Natives.

Plants are \$5 each.
Trees are \$10 each.

SAVE THE DATE

NATIVE PLANT FESTIVAL
SATURDAY, SEPTEMBER 7

DONATION CORNER

Tree of Life
In Memory of Eileen Ely
Earl and Christa Rindfleisch

In Memory of Bob Mooney
Kristen and Brennan Ashby

Oenslager Nature Center
Monetary donation
Joseph and Cheryl Belle

In Memory of Bob Leget
M.P. and D.D. Dowling